

## TECHNICAL DATA

- Input voltage: 15 V DC, cigarette lighter 12 V DC
- Battery type: LiFe (Lithium Iron Phosphat)
- Energy content: 6,6 Wh
- Battery current: 500 mAh
- Max. current: 5 A
- Inflator efficiency: Fill up nachfolger HY5 series in 3 minutes
- Max. pressure: 0,9 bar
- Operation temperature: -20°C – +60°C
- Size: 55 mm x 45 mm x 200 mm

nachfolger GmbH  
Boecklinstrasse 59 / 2  
1020 Vienna  
Austria, EU

[www.nachfolger.com](http://www.nachfolger.com)  
[info@nachfolger.com](mailto:info@nachfolger.com)

C101\_802\_D



# nachfolger<sup>®</sup> pump

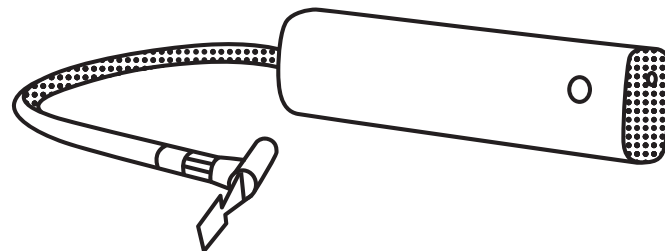

compatible with  
nachfolger series

## OPERATION OF THE PUMP

The mobile pump allows maximum flexibility, as well as mobility and further intensifies the simplicity of the nachfolger series.

## FUNCTION OF THE PUMP

- Connect the tube (E) with the pump first.
- Connect the hose connector (C) tight to the car seat and lock it.
- Activate the indicator on the car seat. Make sure that the indicator on the car seat flashes red slowly.
- Press the button (A) briefly 3 times to activate the pump.
- The button flashes blue, when the activation of the pump was successful.
- After pressing the button (A) once more the pump inflates the seat automatically.
- When the correct pressure is reached, the pump switches off automatically.
- Afterwards the pump function can be switched off by pressing the same button (A) for a few seconds.
- If the pump is not used for 30 seconds, it must be activated again.
- If the pump batteries are empty the button (A) flashes blue quickly.

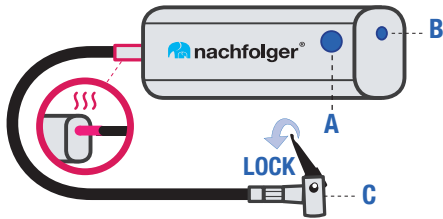

### Charging the pump:

Use the supplied USB cable (F) for charging by connecting it with the charge socket (B). You can charge the pump via USB or connect it with a power adapter (not included) with the USB cable and plug it into a power outlet. While charging the small light on the USB cable glows red. When the light turns off, the pump is fully charged. The higher the amp value of the charger, the faster it will charge.

## WARNINGS

- Please read the user guide of the car seat carefully before using it the first time.
- After filling the seat, the hose connector (C) of the pump must be removed from the seat valve, otherwise the valve remains slightly open.
- Please note, that the tube will get hot after the inflator has worked for a long time.
- If the car seat is filled by other pump or compressor make sure that the pressure applied to the car seat is not higher than 1,0 bar.
- Especially when traveling by airplane, ensure that the pump will not be activated accidentally by other objects.

## PACKAGE

- 1x Inflator (D)
- 1x Tube with air hose (E)
- 1x USB charger cable (F)
- 3x Sealing rings (G)
- 1x Hand bag (H)
- 1x User manual

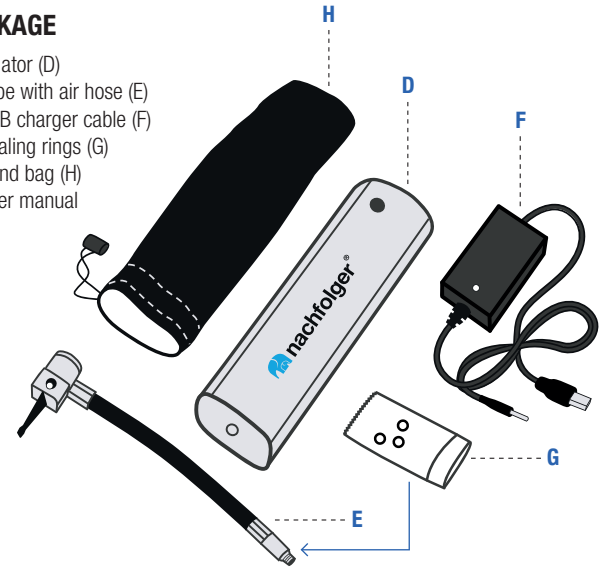

Made in China

